

## Fact Sheet for Partner Universities 2022/2023

<b>Name of the Institution</b>	Hochschule Luzern <b>Lucerne University of Applied Sciences and Art</b>
<b>Name of the School</b>	Hochschule Luzern - Informatik <b>School of Computer Science and Information Technology</b>
<b>Address</b>	International Office Campus Zug-Rotkreuz Suurstoffi 1 CH-6343 Rotkreuz
<b>Website</b>	<a href="https://www.hslu.ch/en/lucerne-school-of-information-technology/international/">https://www.hslu.ch/en/lucerne-school-of-information-technology/international/</a>
<b>Email address</b>	<a href="mailto:International-i@hslu.ch">International-i@hslu.ch</a>
<b>Erasmus Code</b>	CH Luzern14
<b>Information for Exchange Students</b>	<a href="https://www.hslu.ch/en/lucerne-school-of-information-technology/international/studieren-in-rotkreuz/">https://www.hslu.ch/en/lucerne-school-of-information-technology/international/studieren-in-rotkreuz/</a>
<b>Contact Persons</b>	
<b>International Relations</b>	Prof. Dr. Sita Mazumder, <a href="mailto:Sita.mazumder@hslu.ch">Sita.mazumder@hslu.ch</a> +41 41 757 68 81
<b>International Relations</b>	Daniela Stoll, <a href="mailto:Daniela.stoll@hslu.ch">Daniela.stoll@hslu.ch</a> +41 41 228 41 36
<b>Incoming and Outgoing Exchanges / Nominations</b>	Selma Crosby, <a href="mailto:Selma.crosby@hslu.ch">Selma.crosby@hslu.ch</a> , +41 41 757 68 08 Annik Scholzen, <a href="mailto:annik.scholzen@hslu.ch">annik.scholzen@hslu.ch</a> , +41 41 757 68 13 <a href="mailto:International-i@hslu.ch">International-i@hslu.ch</a>

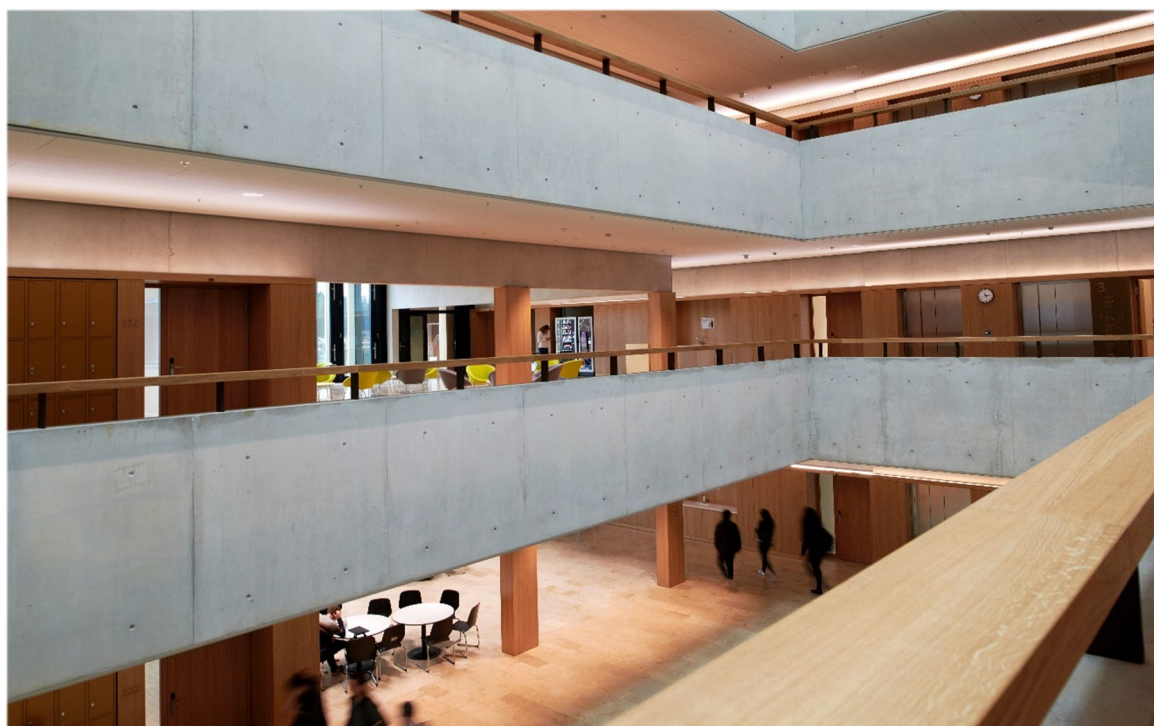

<b>Important Dates</b>	
Up to date Semester dates can be found on our <a href="#">website</a>	
Fall Semester 2022	<a href="#">Introductory weeks</a> for new Exchange Students: 5 – 18 September 2022
	Lessons: 19 September till 23 December 2022 Exam period: January and beginning of February 2023 <sup>1</sup>
	Public Holidays: <ul style="list-style-type: none"> <li>• 1 November 2022 (All Saints' Day)</li> <li>• 8 December 2022 (Immaculate Conception Day)</li> </ul>
Spring Semester 2023	<a href="#">Introductory weeks</a> for new Exchange Students: two weeks before the semester starts
	Lessons: 20 February till 3 June 2023 Exam period: mid-June – beginning of July 2023 <sup>1</sup>
	Public Holidays: <ul style="list-style-type: none"> <li>• 7 April 2023 (Good Friday)</li> <li>• 10 April 2023 (Easter Monday)</li> <li>• 18 May 2023 (Ascension Day)</li> <li>• 29 May 2023 (Whit Monday)</li> <li>• 8 June 2023 (Corpus Christi)</li> </ul>
<b>Introductory Weeks</b>	During the <a href="#">introductory weeks</a> we help students to settle down in Lucerne / Rotkreuz, organise different social events, offer courses like English for Studying, etc.
<b>Nomination &amp; Application Deadlines</b>	Nomination by <a href="#">E-mail</a> : <b>15 April</b> Application online: 30 April for the following Fall Semester  Nomination by <a href="#">E-mail</a> : <b>15 October</b> Application online: 31 October for the following Spring Semester  After nomination of the student will receive access to our online registration Tool in order to complete his application.
<b>Academic Information</b>	
<b>Programmes and courses</b>	<a href="https://www.hslu.ch/en/lucerne-school-of-information-technology/international/studying-in-rotkreuz/">https://www.hslu.ch/en/lucerne-school-of-information-technology/international/studying-in-rotkreuz/</a>
<b>Grading System</b>	From 1 – 6 (6 is the best grade, 1 is the lowest grade. Passing grade is 4)
<b>ECTS System</b>	The Lucerne University of Applied Sciences and Arts fully subscribes to the ECTS System and allocates ECTS credits to all undergraduate and postgraduate programs. In line with ECTS requirements, 60 credits measure the workload of a full-time student during one academic year.
<b>Full-time Study Load</b>	max. 30 ECTS per Semester
<b>Language Requirements</b>	Proof of English Proficiency at least B2 level (if applying for courses taught in English and if not mother tongue) or Proof of German Proficiency at least B2 level (if applying for courses taught in German and if not mother tongue)
<b>Language Courses</b>	The University offers a range of language courses in its <a href="#">language centre</a> .

<sup>1</sup> All incoming students are expected to stay in Switzerland till end of the exam period. If this is not possible, the student is responsible for contacting the lecturers and the International Office in order to organize the exams accordingly.

<b>Course Registration</b>	The exchange programme coordinator of the Lucerne University of Applied Sciences and Arts will do the course registration for you according to your predefined learning agreement.
<b>Transcripts of Records</b>	Transcripts are generally available few weeks after the final exams. The Exchange Programme Coordinator will send the official transcript to the student's home institution and a copy to the student by email.
<b>Further Information for International Students</b>	
<b>General Information for incoming students</b>	Information on courses available in English, student guide, application process: <a href="https://www.hslu.ch/en/lucerne-school-of-information-technology/international/studying-in-rotkreuz/">https://www.hslu.ch/en/lucerne-school-of-information-technology/international/studying-in-rotkreuz/</a>
<b>Accommodation</b>	<a href="https://www.hslu.ch/en/lucerne-university-of-applied-sciences-and-arts/campus/living-in-lucerne/wohnen/">https://www.hslu.ch/en/lucerne-university-of-applied-sciences-and-arts/campus/living-in-lucerne/wohnen/</a> Room bookings can be made via our mobility online tool. Booking period for fall semesters start on 15 May for students from partner universities. Free mover students can book as of 1 <sup>st</sup> June. Booking period for spring semesters start on 15 November for students from partner universities. Free mover students can book as of 1 <sup>st</sup> December.
<b>Buddy Program</b>	The buddy program is run by <a href="https://luzern.esn.ch/buddy-system">ESN Luzern</a> (Erasmus student network). Incoming students can sign up for a buddy via their website: <a href="https://luzern.esn.ch/buddy-system">https://luzern.esn.ch/buddy-system</a>
<b>Visa Information</b>	<a href="https://www.hslu.ch/en/lucerne-university-of-applied-sciences-and-arts/campus/living-in-lucerne/einreise/">https://www.hslu.ch/en/lucerne-university-of-applied-sciences-and-arts/campus/living-in-lucerne/einreise/</a>
<b>COVID-19</b>	<a href="#">Current Information</a> and <a href="#">FAQ</a> Students who have to go into quarantine will receive organisational support for organising quarantine accommodation from LUASA. The LUASA accepts all Incomings / International Students even if they come from a high-risk country (according to the <a href="#">list made by the Swiss Government</a> ).

