

UWE Study Abroad International Exchange Opportunities

UWE Bristol is a future-focused university, locally embedded with global reach.

Our students, relevance and impact are at the heart of everything we do.

Our priority is to deliver an outstanding university experience for our students through innovative, practice-led, research-informed courses.



UWE Overview



Over 38,000 students enrolled



21% international students



Bristol voted number 1 city in the UK (Sunday Times 2017)



24th out of 121 UK Institutions (The Guardian University Guide, 2023)

Don't just take our word for it – the facts speak for themselves.

94%

of UWE Bristol international first-degree graduates are in employment or further study six months after graduation.*

TOP 20

university in the UK for graduate employment prospects.**

TOP 2

in England for student satisfaction. (excluding specialist HEIs).**

TOP 500

in the Times Higher Education World University Rankings, 2021.

Sources:

* DLHE (Destination of Leavers from Higher Education) survey published in 2018

** The National Student Survey 2020





The Student City



**UWE
Bristol**



Unbeatable Bristol

- Bristol is an exciting, multicultural city with a lot to offer students
- Excellent social and cultural activities
- Vibrant cultural, art & music scene
- 90 minutes by train from London



- Truly a multicultural student city – over 187 countries , speak over 91 languages
- Brilliant links with industry; Bristol is a Digital hub
- Rated ‘a desirable city ’ - "a small city that feels like a big city" (The Sunday Times, Best Places to Live Guide 2017)
- Easily accessible; links to major cities and Europe



Exchange Student Support

- Bookable airport transfers (from London Heathrow)
- International student orientation programme (September and January)
- Global Support Buddies
- Weekly drop-in sessions in a global space - relax in our lounge, meet friends & practice speaking English
- Weekly Global & Conversation Cafés - take part in fun activities with other international and European students
- English language & Communication skills workshops



Student Life

- UWE Bristol Students' Union – over 180 sports clubs, societies and networks
- Faith and culture societies
- Events – Film nights / Speed friending / crafting
- UWE Centre for Music
- UWE Centre for Sport
- Volunteering opportunities

Hello!

Our Global Ambassadors
will be waiting to welcome
you to UWE Bristol!



Campus Life

Healthy, safe, sustainable and inclusive campuses!

Check out our virtual Campus tours

[Frenchay | Guided tours | UWE Bristol Virtual tour](#)

[City | Guided tours | UWE Bristol Virtual tour](#)



Excellent accommodation offerings

UWE Bristol has a wide range of quality accommodation options, with access to great facilities whether students are living on or off campus

Images shown: Wallscourt
Park Frenchay Campus

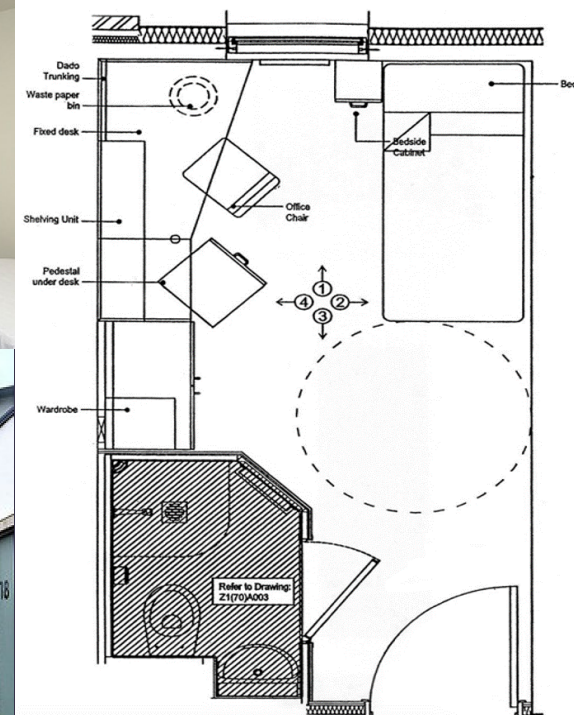

Student Visa Information

- UWE Bristol Immigration Advice team
- Online and in person support
- Short term visitor visa (less than 6 months)
- Student Visa (one academic year)



**UWE
Bristol**

UWE Study Abroad

[International Exchange Opportunities](#)

[Support for Study Exchange students](#)

[How to Apply](#)

Contact UWE Bristol Study Abroad team
studyabroad@uwe.ac.uk



UWE Bristol Student Exchange Factsheet

Contents

Term Dates & Exchange Durations	3
January Assessments and Semester 1 exchange students	4
Exchange Application Deadlines	4
Exchange Application Process.....	4
Visa Information.....	5
Taught Language.....	5
Airport Transfers.....	5
University Managed Accommodation	6
Private Accommodation	6
Council Tax.....	6
Student Support.....	7
Access to health care and Health insurance	8
Costs.....	8
Study Options.....	9
Certificates of Credit (Transcripts).....	9
Registration & Timetables	9
Starting Block	9

Full name: **University of the West of England**

Short name: **UWE Bristol**

Location: **Bristol, Southwest England, United Kingdom.** 120 miles west of London.

Students: **38,000** (including 8,000 International students)

Contact: **Global Mobility Team:** Studyabroad@uwe.ac.uk

3 Campuses:

[Frenchay Campus](#)

Bristol Business School; Bristol Law School; School of Architecture and Environment; School of Social Sciences

[City Campus](#) (Also known as Bower Ashton Campus): School of Arts

[Glenside Campus](#) : School of Health and Social Wellbeing

Web Links:

[Incoming Exchange Students](#)

[Main UWE website](#)

[College and Schools](#) (Faculties and Departments)

[Campus Facilities](#)

[Discover Bristol](#)

Term Dates & Exchange Durations

[Term Dates](#)

Full academic year: September to June

Semester 1: Autumn Semester: September to January

Semester 2: Spring Semester: January to June

Please note that [School of Arts](#) programmes are only able to send and receive exchange students during Semester 2

January Assessments and Semester 1 exchange students

Semester 1 students who wish to return to their home institution with UWE credit must ensure they are present for the January assessment period *if required*.

Many courses now offer electronic submissions, so it may not be necessary to sit an exam in Bristol – students are advised to check with their course leaders on arrival.

Exceptions are made for a small number of partners where the student's home University term *starts prior* to the end of UWE's examination period.

UWE does not offer the option for incoming students to sit exams required for their home university on campus at UWE. Incoming students will need to arrange an alternative form of assessment with their home university.

Nomination Deadlines

31st March for Semester 1 and full-year study commencing in September

30th September for Semester 2 commencing in January

Exchange Application Deadlines

1 May for Semester 1 and full year study commencing in September.

31 October for Semester 2 commencing in January.

Exchange Application Process

1. Nomination by home University to studyabroad@uwe.ac.uk
2. Link to online Admissions application form sent direct to student email address

Students intending to study in the [School of Arts](#) should send an electronic portfolio prior to arrival to ensure they are placed in the correct subject area.

Following application, official University communication with incoming students will be via the student **Welcome Website**. Students will be sent a login ID and a password via email once their application has been processed. All information about joining the University, Visa instructions, Airport transfers, Registration and the International Student Orientation will be provided here.

Visa Information

Terminology: If you require a Visa to enter the UK you are a 'Visa national'.

As an exchange student you will be coming to the UK to study a Higher Education course.

Visa nationals studying for **longer than 6 months**, or visa nationals who intend to combine study with work will require a [Student Visa](#).

Visa nationals studying for **less than 6 months** may require a [Standard Visitor Visa](#).

We recommend that everyone checks their Visa requirements here: <https://www.gov.uk/check-uk-visa>

The Study Abroad & UWE Admissions teams will provide the appropriate documentation to support students in their visa application. If a student requires a visa to study in the UK it is the responsibility of the student to ensure compliance with the requirements of the visa that is issued.

It is essential that you get the correct Visa, if one is required, for your study in the UK.

Students who are nominated for Semester 1 **cannot** extend their exchange to full year after they have arrived in the UK. This is due to Visa regulations. Any extension requests must be made by the student prior to arrival and in sufficient time to be issued with a Student Visa for the start of the year.

Taught Language

Students are expected to arrive with a sufficient level of English in order to be able to follow classes and submit all assessments in English. We recommend a minimum of [B1 CEFR](#).

For exchange students, proof of English language is not normally required for entry to the programme – but may be required by the UK Government, if necessary, for Visa purposes.

UWE's [English Language and Academic Skills Unit](#) provide Study Support workshops, seminars and drop-in sessions to support students with their studies.

Airport Transfers

UWE offers a no-cost Airport Transfer Service for new students. This operates from London Heathrow International Airport at the start of each semester prior to the International Student Orientation programme. Up to date details will be published on our web pages here:

<https://www.uwe.ac.uk/life/preparing-and-arrival/airport-welcome-international>

University Managed Accommodation

<https://www.uwe.ac.uk/life/accommodation>

Students will be invited to apply for accommodation after completion of the exchange application. Please note that students cannot apply for accommodation prior to submitting an exchange application.

Applications for university managed accommodation opens on 13 June 2024. We recommend students make it a priority to apply for accommodation as soon as possible.

Accommodation contracts run alongside UWE's [term dates](#). This means that accommodation contract dates are **not flexible**; instead they follow the structure of our 3-term academic year, with most contracts running until the end of December for students attending UWE for Semester 1 only, and June or Mid-July for students attending UWE for full year or Semester 2.

[UWE accommodation](#) includes the cost of gas and electricity; [Contents insurance](#) for personal possessions (excludes bicycles); Internet Connection (with the exception of University houses) and costs between £4,1843.13 and £8,547.00 for a 40 -45 week contract.

Accommodation Services can be contacted as follows: +44 (0) 117 32 83601
accommodation@uwe.ac.uk

Private Accommodation

<https://www.uwe.ac.uk/life/accommodation/private-accommodation>

If students wish to find private accommodation, they can do so with advice via the above link. If students wish to stay in Bristol while doing this there are many hostels available. Online research and booking is recommended.

Council Tax

Exchange students in *private* accommodation need to provide evidence of their student status to Bristol City Council to prove their [exemption from paying Council Tax](#).

Each student staying in private accommodation should complete the online form found on the Bristol City Council website to see if they are eligible for exemption.

Students staying in UWE accommodation will not be liable for Council Tax.

Further information on [council tax](#) can be found on the UWE website.

Student Support

The [Study Abroad team](#) work closely with students' home institutions and academic departments to ensure the smooth running of study exchanges and are happy to answer queries from incoming exchange students.

The team should be the first contact point for all queries: studyabroad@uwe.ac.uk

UWE's [Global Student Support](#) team coordinate the International Student Orientation. All exchange students are recommended to participate in orientation events and activities – designed to help students meet people, have fun and to get to know UWE, Bristol and each other! We recommend students to keep up to date with all that the Global Centre has to offer via [Instagram](#) .

The Orientation programme will be available [online](#) as soon as it is finalised.

Our [Student Support Advisers](#) can provide students with information on a wide range of University matters, including module choices, academic regulations and extenuating circumstances. Students can also discuss academic issues with their departmental exchange coordinators or with their module leaders.

Student advisors can give guidance on [managing money](#) as well as [Visas, Immigration and the UK's PBS](#) (Points based system).

Our [Wellbeing Service](#) provides support for students experiencing personal issues.

Our [Faith and Spirituality](#) service provides facilities and information for prayer, worship, meditation and reflection, opportunities to meet others and advice on spiritual and ethical concerns.

UWE's Students' Union (UWESU) has over 30,000 members and works to promote, defend and extend the rights of students, to initiate change and to enhance the student experience. [UWESU's advice centre](#) can help with money matters, employment, housing and other matters.

[UWESU clubs and societies](#) offer opportunities to join networks, sporting clubs, societies and more.

Access to health care and Health insurance

The University's [Health Centre](#) based on the Frenchay campus treats students for minor injuries and illnesses.

All non-UK students can register with a Doctor free of charge.

The UK's National Health Service (NHS) provides free hospital treatment, free access to doctors, fixed charges for medicines and fixed charges for dentistry and opticians. Most EU, UK and International students studying for longer than six months can register for a HC1 certificate which allows them to reclaim the costs of paid-for services.

Visa nationals studying in the UK on a course less than six months long will need to arrange their own health insurance.

To make an appointment to see a Doctor (known as a 'GP'), students must first register with a practice (a Doctor's surgery). Full information can be found here:

<https://www.uwe.ac.uk/life/health-and-wellbeing/access-health-services/university-health-centre>

However, if a student has a more urgent need to see a medical professional, they can visit an 'NHS walk-in centre'. These facilities do not require an appointment in advance.

Full information can be found here: <https://www.bristol.gov.uk/grt-bristol/health/doctors-and-walk-in-centres>

Costs

For exchange students from partner institutions studying for a full year, tuition is free for up to 120 UWE credits (60 ECTS).

For exchange students from partner institutions studying for a single semester, tuition is free for up to 60 UWE credits (30 ECTS).

Students are responsible for all personal expenses, including accommodation costs.

For a 9-month course, students should expect their living costs (including accommodation) to be approximately £7,200 – this will vary according to personal habits.

UWE accommodation costs between approx. £4,148.34 and £7,679.88 for a 40 - 45 week contract and includes most bills, whereas Private accommodation costs upwards of £3,500 a year, excluding bills.

Study Options

Please note that cross-department study is not permitted. You will only be able to study subject areas noted in the exchange agreement between institutions. This is due to multiple campuses and timetable clashes.

Please be aware that exchange students are usually allocated to study modules (courses) during level 2 (year2) of the Bachelor's programme, unless specifically agreed otherwise in advance of registering at UWE.

Certificates of Credit (Transcripts)

At the end of the academic year, students who have passed modules at UWE will receive an official Certificate of Credit (also known as a Transcript). We are only able to list modules that students have *passed* on the certificates. Any module a student has failed to pass will *not* be included.

Certificates are only produced after the UWE Award Boards have been completed. This is normally about 6 weeks after the end of the exam period.

We will send **electronic copies only**.

Students who require a paper copy of the Certificate of Credit will need to request this here: <https://www.uwe.ac.uk/study/academic-information/certificates/duplicate-credit-certificates>

There will be a small charge for this service.

Registration & Timetables

Students must have completed the UWE registration process and Learning Agreement (module choices) and have waited up to 3 working days following completion of the online registration process to see your timetable.

<https://www.uwe.ac.uk/life/preparing-and-arrival/registration>

Timetables will be available via MyUWE from 4th September.

Starting Block

[Starting Block](#) is a suite of activities to help you get settled into UWE.

As an exchange student, rather than having a fixed schedule linked to a specific programme of study, you have the option to create your own schedule based on your key needs and interests.

For this reason, you will not see Starting Block Activity in your timetable – many of the activities can be accessed at the time that best suits you – however please check any events or activities in the link above to ensure you don't miss out. In some cases, you won't be able to access the platforms used to deliver the activities until your registration has been finalised, but many of the videos are available via open access platforms like YouTube.